

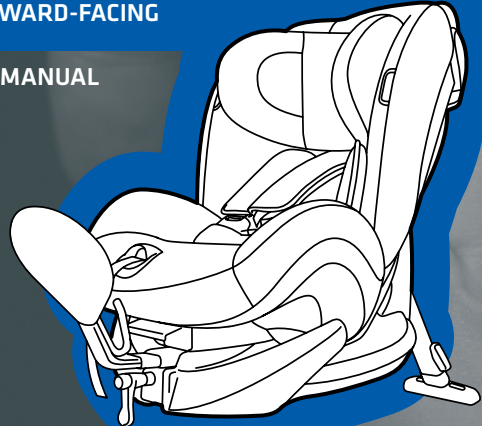

izi Plus

REARWARD-FACING

USER MANUAL



ECE R44 04

GROUP
0+/1/2

WEIGHT
0-25 kg

AGE
6m-5y

BeSafe®



BeSafe®

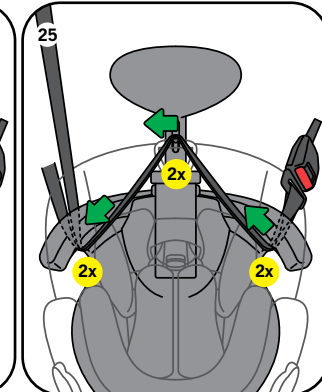
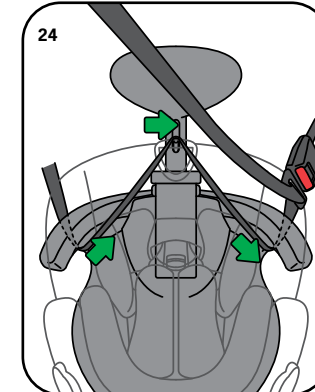
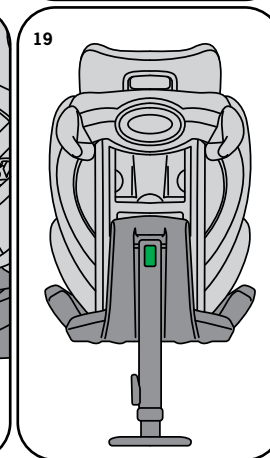
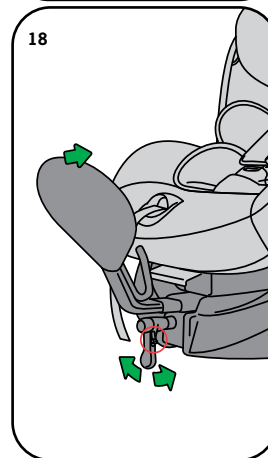
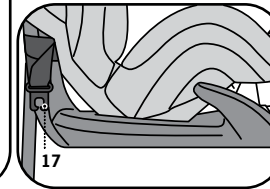
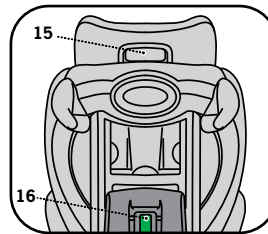
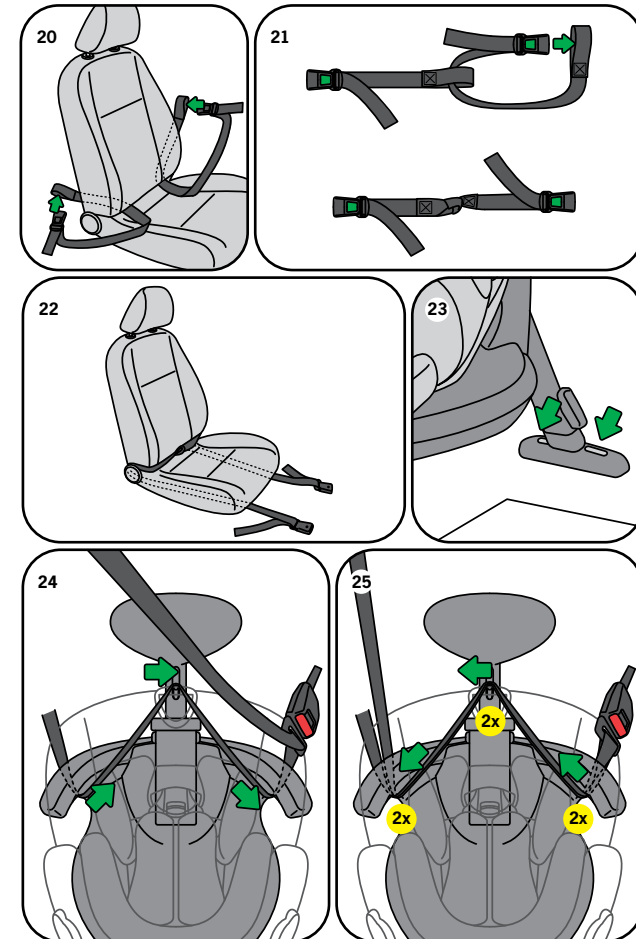
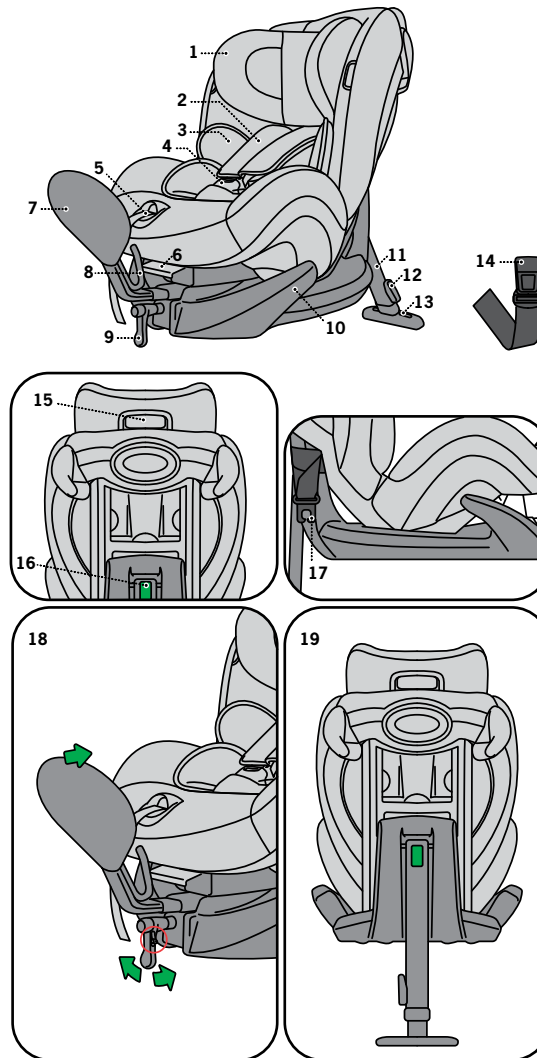

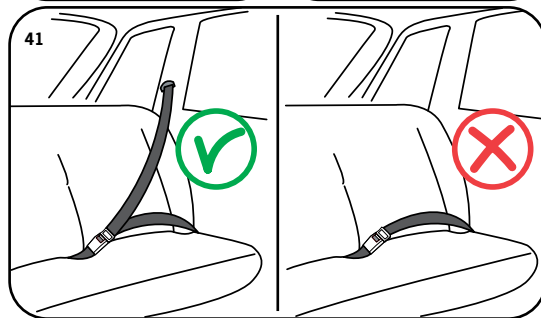
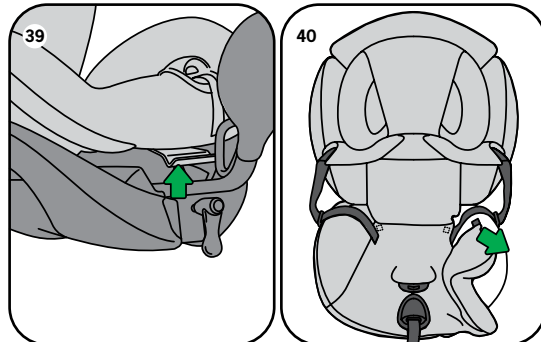
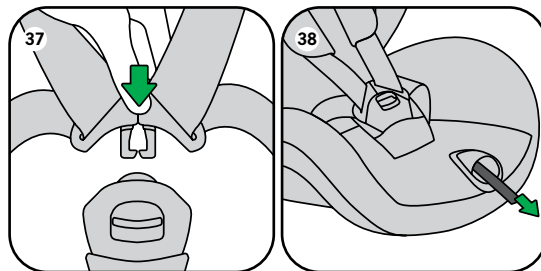
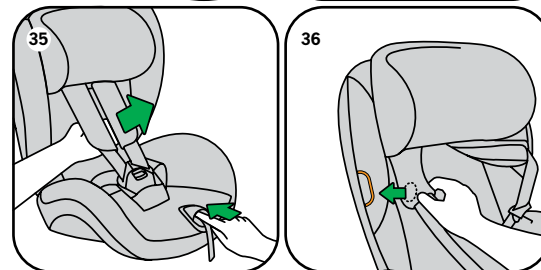
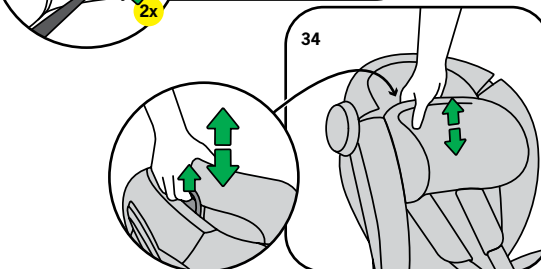
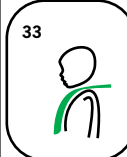
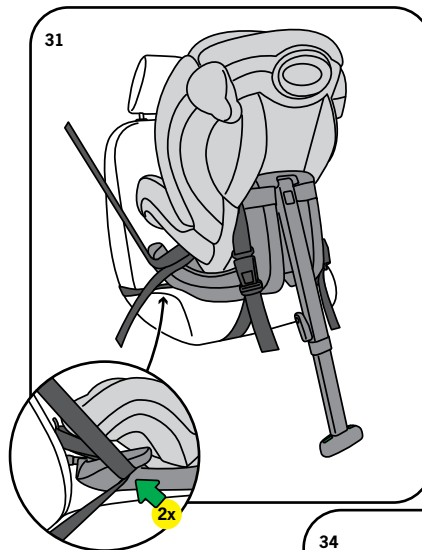
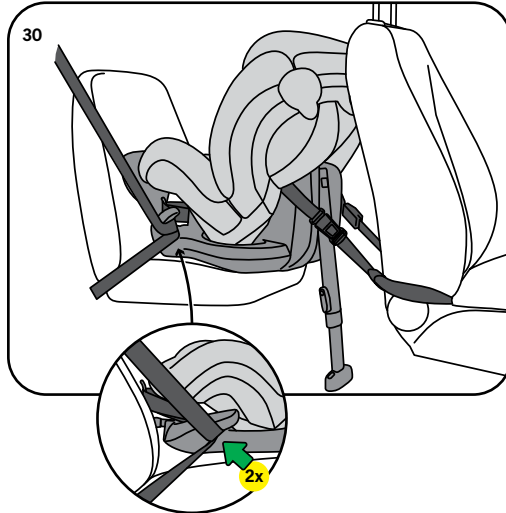
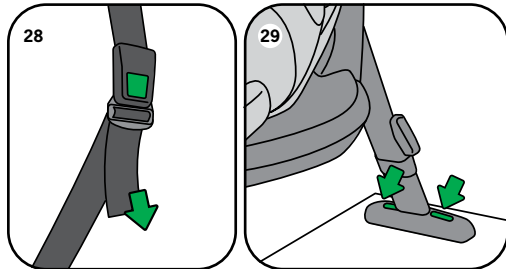
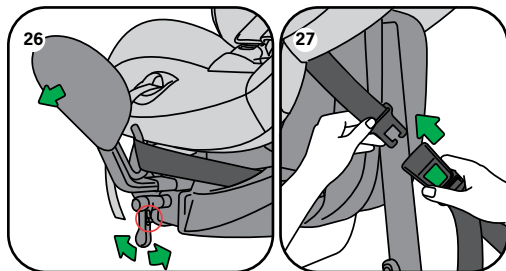

Thank you for choosing BeSafe iZi Plus

BeSafe has developed this seat with much care, to protect your child during the first phase of her or his life.

- ! It is important that you read this user manual BEFORE installing your seat. Incorrect installation could endanger your child.

Contents

Vital information	8
Rearward-facing belt installation	10
Removing the seat	14
Positioning the child	15
Sleeping position	15
Removing and refitting the cover	16
Cleaning instructions	16
Warning: potential misuse	17
Important advice	17
Guarantee	19
Point of sale information	19

! Vital information

- It is NOT ALLOWED to mount the seat in a front passenger seat WITH AN ACTIVATED AIRBAG.
- iZi Plus can be installed only rearward-facing with a 3-point car belt, approved to UN/ECE Regulation No. 16 or other equivalent standards.
- iZi Plus is approved in groups 0+, 1 and 2, rearward-facing from 0-25 kg.
- Read the car list to find out whether your car model is approved to use the seat. Check www.besafe.com for the most updated carlist.



- The harness straps must always be locked when the child is in the seat.
- The harness straps must be tightened without slack and not twisted. You should not be able to get more than one finger between the harness and your baby (2cm).
- The cover of the shoulder strap contains magnets. Magnets can influence electronic equipment such as pacemakers.
- The floor support must always be used. Make sure that the floor support is fully pushed down.
- We recommend that this seat is used only for children who can sit upright, so not younger than 6 months.
- For children under 1 year and/or under 10 kg weight, we recommend that the most reclined sitting position and the body hugger and seat cushion are used.
- Remove the baby cushion (extra available accessory) when the child is older than 1 year.
- Remove the body hugger when the child is older than 2 years.
- When the child weighs over 25 kg or the shoulders are higher than the bottom side of the head rest, the child must change to a group 2/3 seat.
- After an accident, the seat must be replaced. Although it may look undamaged, if you were to have another accident, the seat may not be able to protect your child as well as it should.
- Prevent the seat from becoming trapped or weighed down by luggage, seats and/or slamming doors.
- Before every use, make sure the harness is not damaged or twisted.
- Do not use the seat if any components are broken or missing.
- If in doubt, consult either the child restraint manufacturer or the retailer.

Rearward-facing belt installation

Crucial parts

1. Adjustable head rest
2. Shoulder straps (2x)
3. Body hugger
4. Harness buckle
5. Central adjuster
6. Reclining lever
7. Front brace
8. Belt guiding hook
9. Ratchet for front brace
10. Belt guiding horns (2x)
11. Floor support
12. Height adjuster floor support
13. Floor support height indicator
14. Anchor belt (2x)
15. Release handle head rest
16. Floor support position indicator
17. Connector for anchor belt (2x)

! It is NOT ALLOWED to mount the seat in a front passenger seat WITH AN ACTIVATED AIRBAG.



1. When mounting in the front seat of the vehicle, adjust the back rest of this vehicle seat in an upright position. When mounting in the back seat of the vehicle, push the front seat of the vehicle forward as much as possible.
2. Install the front brace by sliding the two pins in the oval tube under the front side of the seat. Move the front brace inwards with the ratchet. The ratchet is used to adjust the front brace in both directions. Slide the knobs (see red circle) on the ratchet up or down to change direction. (18)
3. Fold down the floor support before you install the seat in your vehicle. (19)

4. Check if the floor support is folded totally downwards as shown on the green sign at the top side. (19)
5. Before you can install the seat in the vehicle, you have to mount 2 anchor belts which will be connected with the connectors at the backside of the child seat. The anchor belts have to be connected with the vehicle.



Installation on the back seat

- Insert the belt loop through the gap between the seat cushion and the seat back on the front seat of the vehicle. Then bring the locking device through the belt loop and tighten. (20)



Installation on the front seat

- Join the 2 anchor belts together to make a single belt. Put the lock of belt 2 through the loop of the belt 1 and then through the loop of belt 2. Pull it firmly. (21)
 - Put the middle part of the anchor belt over the inner part of the vehicle seat. Bring the two ends of the anchor belt under the front seat of the vehicle and bring them upwards to the seat. (22)
- If these methods do not work in your car refer to www.besafe.com for alternatives.

With the anchor belts in place the installation can continue:

1. Place the seat sideways into the car with the front brace towards you.
2. Turn the seat into the right position (with the front brace against the back rest).
3. Position the floor support around 5cm. above the floor.
4. The height indicator of the floor support shows grey when the floor support is above the floor. (23)
5. In the front seat of the vehicle, you should position the seat against the dashboard. If it is not possible to obtain contact with the dashboard, position the front seat of the vehicle as far as possible backwards, preferable with a minimum distance between child seat and dashboard of 25 cm.
6. Position the 3 point car belt. Place the hip belt over the base of the seat behind the belt guiding horns on each side and the belt hook close to the front brace. Fasten the car belt, CLICK! (24)
7. Pull out all slack of the hip belt.
8. Place the shoulder belt following the same routing as the hip belt behind the belt guiding horns on each side and behind the belt hook. The shoulder belt will twist over the hip belt, which is OK. (25)
9. Pull out all slack of the shoulder belt.
10. Move the front brace outwards with the ratchet. Continue tightening until the brace is pressed well into the back rest of the vehicle seat. (26)
11. Check if the hip belt is tensioned very tight. If not repeat the installation of the car belt.
12. Connect the anchor belts with the child seat. (27)
13. Tighten the anchor belts as tight as possible. It's most easy to start with the anchor belt at the inside of the vehicle. (28)
14. Adjust the floor support so it is in contact with the floor of the vehicle. Tension the anchor belts again till they are really tight. (28)
15. The height indicator of the floorsupport shows green when the floor support is in contact with the floor. (29)
16. If you are installing against the dashboard and the seat is not in contact with the dashboard yet, release the anchor belts and position the floor support to the shortest length.
17. Tighten the anchor belts again till the seat is in contact with the dashboard.
18. Adjust the floor support so it is in contact with the floor of the vehicle.
19. Positioned in the back seat of the vehicle, you should, if possible, push the front seat of the vehicle backwards, so that it is in contact with the child seat. If it is not possible to obtain contact with the child seat, push the backrest of the front seat of the vehicle forward so that the distance between child seat and back rest of the front seat of the vehicle is minimum 25 cm.
20. Adjustments of the front seat of the vehicle might bring slack in the anchor belts; tighten the anchor belts again.
21. To enlarge the space for the legs of the child, you can move the front brace outwards with the ratchet. Keep this space as small as possible.
 - iZi Plus installed rearward-facing in the back seat. (30)
 - iZi Plus installed rearward-facing in the front seat. (31)

Removing the seat

1. If the seat is installed in the back seat of the vehicle, push the front seat of the vehicle forward as much as possible.
2. Move the front brace inwards with the ratchet.
3. Move the floor support to the highest position.
4. Release the anchor belts.
5. Remove the car belt from the front brace and the seat base.
6. Pull the seat back towards the front. Turn the seat so you can easily remove the seat.
7. Remove the anchor belts from the vehicle.

Positioning the child

1. Position of the shoulder straps: Check that the shoulder strap slots are leveled with or a bit under your child's shoulders.
 - too high (32)
 - correct (33)
2. The height of the shoulder straps and the head rest can be adjusted by releasing the release handle at the back of the head rest and pulling the head rest up or down while keeping the head rest upright. (34)
3. Pull the shoulder straps up while pressing the button of the central adjuster. (35)
4. Open the harness buckle.
5. Position the shoulder straps over the orange marking at sides of the seat to keep the harness open while you position the child. (36)
6. When the child is positioned, place the shoulder straps over the child's shoulders and close the buckle: CLICK! (37)
7. Pull the harness strap through the central adjuster in the direction of the green arrow straight up-/forwards. Continue pulling until the harness is a comfortable but firm fit. (38)



- Make sure that the harness straps are always locked and tightened when the child is in the seat.
- Remove the baby cushion (extra available accessory) when the child is older than 1 year.
- Remove the body hugger when the child is older than 2 years.

Sleeping position

- The seat has 3 positions.
- By pulling the reclining lever upwards, the seat can be put in another position. (39)

Removing and refitting the cover

Removing the cover

- Pay attention when you remove the cover, as fitting the cover is done in the opposite way.
- Start to take off the lower seat part. (40)
- The cover of the head rest can be taken off separately by disconnecting the hooks at the backside and pulling off the fabric to the front.

Refit the cover

- Pull the head rest in the highest position. Mount the head rest cover and connect the hooks at the back side. Pull the harness straps through the holes. Connect the loose bottom part of the head rest fabric with the plastic part under the head rest.
- Pull the harness straps through the opening of the seat cover and lock the harness buckle. Pull the crotch strap through the opening of the seat part.
- Mount the top part and then the shoulder parts. Mount the seat part and bring the seat cover under the rear parts of the sidewalls.

Cleaning instructions

- The fabric covers shall be washed according to the instructions on the inside of the covers.
- Clean harness by hand with water and mild soap.
- DO NOT use any aggressive cleaning products; these may harm the construction material of the seat.

! Warning: potential misuse



- It is NOT ALLOWED to mount the seat in a front passenger seat WITH AN ACTIVATED AIRBAG.
- Install only with 3-point car belts, approved to UN/ECE Regulation No. 16 or other equivalent standards. (41)
- DO NOT use the seat without floor support in the most downward position, supported by the floor in front of the vehicle seat.
- DO NOT use the seat without tightening the front brace when mounted rearward-facing.
- DO NOT use the seat without tightening the anchor belts when mounted rearward-facing.

! Important advice

- DO NOT attempt to dismantle, modify or add any part to the seat. Warranty will expire if non-original parts or accessories are used.
- DO NOT use anything, such as a cushion, to raise the child seat off the passenger seat of the vehicle. In an accident the seat will not be able to protect your child in the right way.
- Never leave your child unattended in the seat.
- Make sure all passengers are informed about how to release your child in case of emergency.
- An unoccupied child seat should always be fastened in the vehicle.
- Make sure luggage or other objects are properly secured. Unsecured luggage may cause severe injuries to children and adults in case of accidents.
- Never use the seat without the cover. The cover is a safety feature and may only be replaced by an original BeSafe cover.
- Under the cover we use EPS foam. Do not push or pull too hard against the foam, since you might damage the foam.

- Do not use any aggressive cleaning products; these may harm the construction material of the seat.
- BeSafe advises that child seats should not be bought or sold second-hand.
- KEEP this user manual for later use with the seat.
- DO NOT use at home. It has not been designed for home use and can only be used in a vehicle.

Practical advice

When the child seat is mounted in the car check all the areas where the child seat might touch the interior. We recommend using a (BeSafe) protection cover in these places to avoid cuts, marks or discolouration on the interior of the vehicle, especially in vehicles with leather or wooden interior.

Guarantee

- All BeSafe products are carefully designed, manufactured and tested. All of our BeSafe child seats are tested periodically out of our continuous production in our test laboratory. Furthermore they are tested by independent test institutes.
- Should this product prove faulty within 24 months of purchase due to materials or manufacturing fault, except covers and harness straps, please return it to the original place of purchase.
- The guarantee is only valid when you use your seat appropriately and with care. Please contact your dealer, he will decide if the seat will be returned to the manufacturer for repair. Replacement or return cannot be claimed. The guarantee does not get extended through repair.
- The guarantee expires: when there is no receipt, when defects are caused by wrong and improper use, when defects are caused by abuse, misuse or negligence.

Point of sale information

Notice for REARWARD-FACING installation

- This is a semi-universal Child Restraint System. It is approved to regulation No. 44.04, series of amendments for general use in vehicles fitted with 3-point car belts, approved to UN/ECE Regulation No.16 or other equivalent standards.
- The seat is suitable for fixing into the seat positions of the vehicles listed in the separate 'car list'. Seat positions in other vehicles may also be suitable to accept this child restraint. If in doubt, consult either the child restraint manufacturer or the retailer. For updated car list see: www.besafe.com.

Next car seat

- The BeSafe iZi Up is a group 2/3 seat which can be used for children from 15 till 36 kg, which covers the age group from 4 till 12 years.



HTS BeSafe as
N-3535 Krøderen, Norway - www.besafe.com

BeSafe[®]